

Series 553-001



AVENTICS™ Series 553-001



Air flow sensor, Series 553-001

- diaphragm principle

- Electrical connection Plug, M12x1, 8-pin, A-coded



Mounting orientation	Any
Working pressure min./max.	10 bar
Ambient temperature min./max.	5 ... 50 °C
Medium temperature min./max.	5 ... 50 °C
Medium	Compressed air
Max. particle size	50 µm
Oil content of compressed air	0 ... 1 mg/m ³
Max. power consumption *)	300 mA
Response time	15 ms
Precision (% of full scale value)	See table below
Protection class	IP54
Weight	1.2 kg

Technical data

Part No.	Nominal flow Q _n	Precision (% of full scale value)
	Max., standard	
5530011000	250 l/min	± 3 %
5530011100	500 l/min	± 2 %
5530011200	1000 l/min	± 2 %

Technical information

The pressure dew point must be at least 15 °C under ambient and medium temperature and may not exceed 3 °C .

The protection class is only ensured when the plug is mounted properly. For detailed information, see operating instructions.

Technical information

Material	
Housing	Aluminum

Dimensions

Dimensions

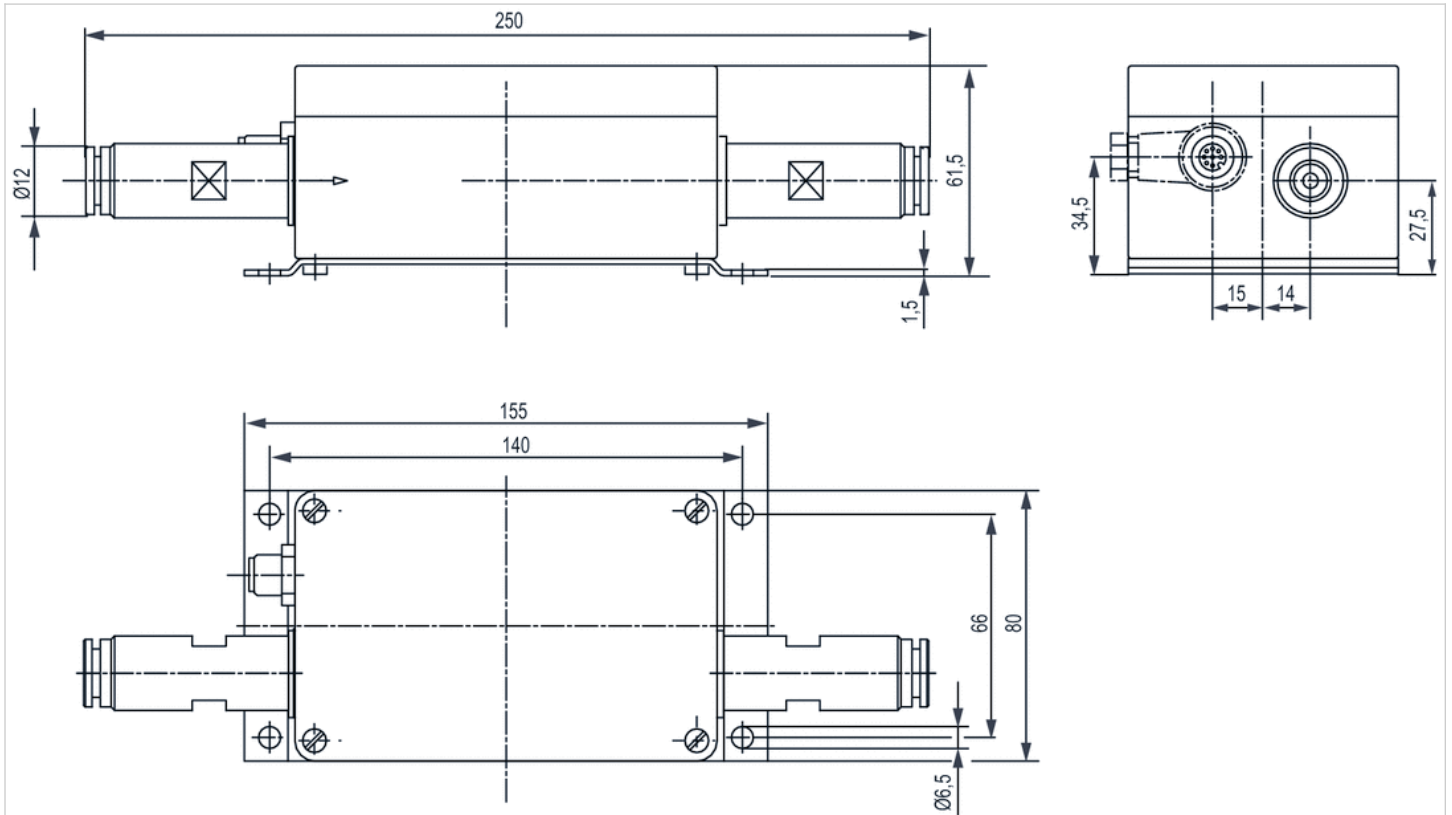

Diagrams

Characteristics

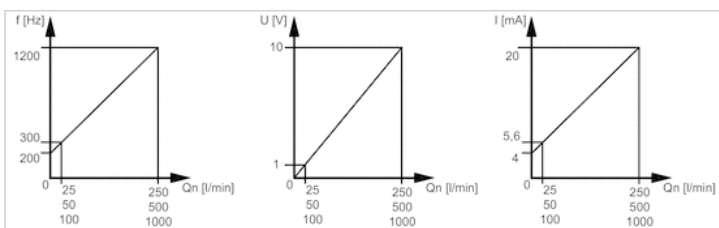

The output signal for the air flow sensor can be selected as a frequency signal, voltage or current. Shield is connected to plug body.

Circuit diagram

Functional diagram

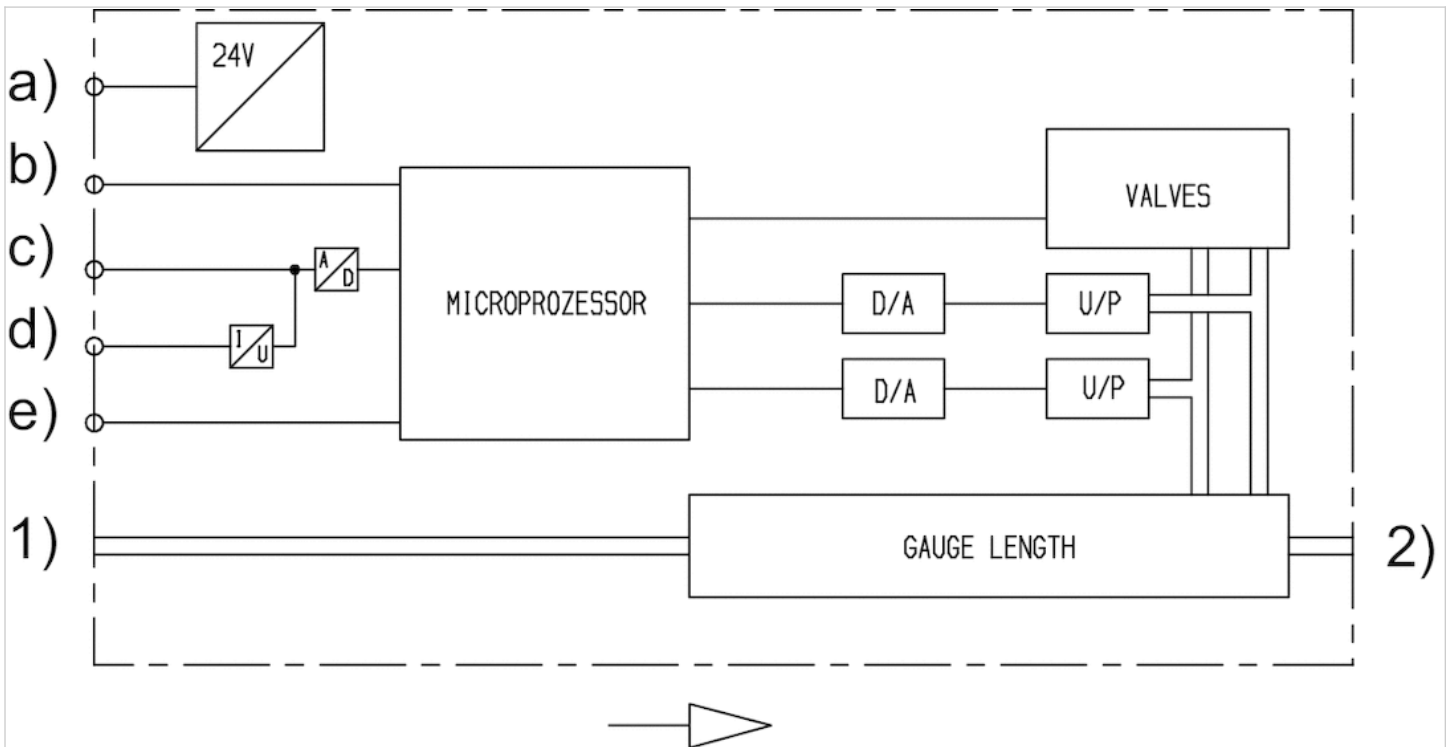

a) supply voltage b) frequency output c) voltage output d) current output e) zero point adjustment
 1) Input 2) Output

Pin assignments

Plug M12, 8-pin



Pin	1	2	3	4
Function status	Supply Voltage	0 V	frequency output	zero point adjustment
5	6	7	8	
Voltage output	current output +	current output -	protective ground PE	

Efficient pneumatic solutions, our program: cylinders and drives, valves and valve systems, air supply management

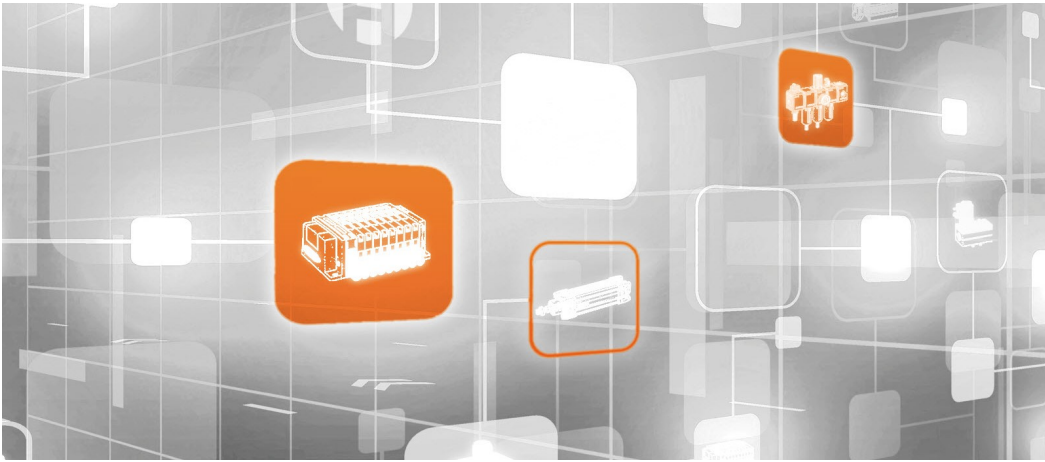

Visit us: [Emerson.com/Aventics](https://www.emerson.com/aventics)

Your local contact: [Emerson.com/contactus](https://www.emerson.com/contactus)



Emerson.com



[Facebook.com/EmersonAutomationSolutions](https://www.facebook.com/EmersonAutomationSolutions)



[LinkedIn.com/company/Emerson-Automation-Solutions](https://www.linkedin.com/company/Emerson-Automation-Solutions)



[Twitter.com/EMR_Automation](https://twitter.com/EMR_Automation)

An example configuration is depicted on the title page. The delivered product may thus vary from that in the illustration. Subject to change. This Document, as well as the data, specifications and other information set forth in it, are the exclusive property of AVENTICS GmbH. It may not be reproduced or given to third parties without its consent. Only use the AVENTICS products shown in industrial applications. Read the product documentation completely and carefully before using the product. Observe the applicable regulations and laws of the respective country. When integrating the product into applications, note the system manufacturer's specifications for safe use of the product. The data specified only serve to describe the product. No statements concerning a certain condition or suitability for a certain application can be derived from our information. The information given does not release the user from the obligation of own judgment and verification. It must be remembered that the products are subject to a natural process of wear and aging.

The Emerson logo is a trademark and service mark of Emerson Electric Co. Brand logotype are registered trademarks of one of the Emerson family of companies. All other marks are the property of their respective owners. © 2017 Emerson Electric Co. All rights reserved.
2019-03



CONSIDER IT SOLVED™